

CRYSTAL LAKE TOWNSHIP

HIGH RISK EROSION AREAS & CRITICAL DUNE AREAS

BENZIE COUNTY

T26N,R16W

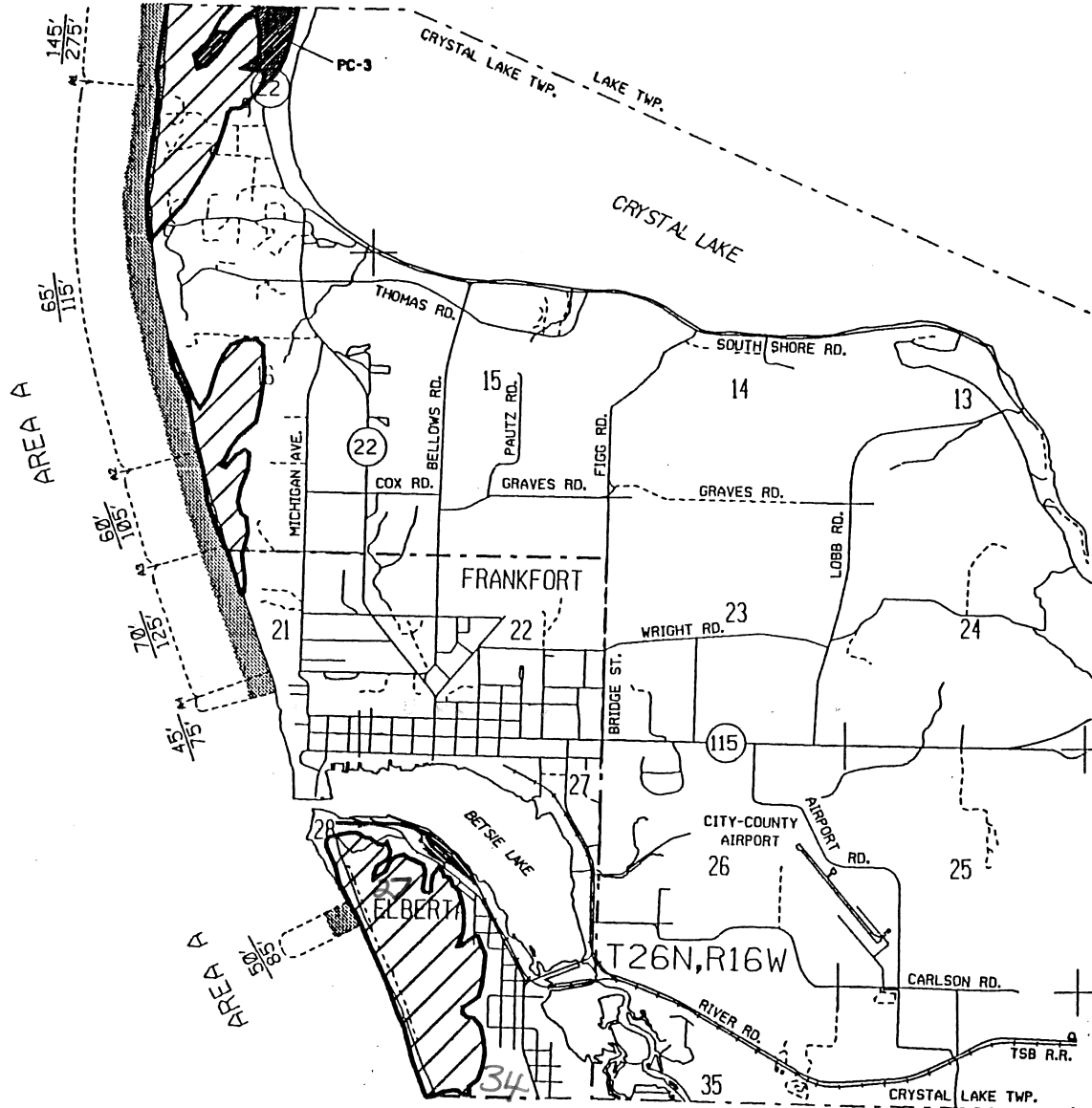
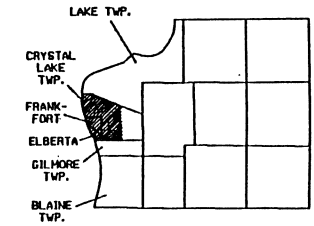

HIGH RISK EROSION AREAS

THE NUMBER REPRESENTS, IN FEET, THE 30 YEAR PROJECTED RECESSION DISTANCE.

THE NUMBER REPRESENTS, IN FEET, THE 60 YEAR PROJECTED RECESSION DISTANCE.

HIGH RISK EROSION AREA (shading alongshore)

THESE AREAS ARE LEGALLY DEFINED BY THE SHORELANDS PROTECTION AND MANAGEMENT ACT, 1970 P.A. 245, AS AMENDED, AS BEING GREAT LAKES SHORELAND AREAS DOCUMENTED TO REcede AN AVERAGE OF ONE FOOT OR MORE PER YEAR.

CRITICAL DUNE AREAS

BARRIER DUNES
BARRIER DUNE FORMATIONS DESIGNATED PURSUANT TO 1976 P.A. 222

AREAS NOT INCLUDED IN DESIGNATED BARRIER DUNE FORMATIONS THAT ARE COMPOSED PRIMARILY OF DUNE SAND AND EXHIBIT SEVERAL DUNE-LIKE CHARACTERISTICS.

EXEMPLARY DUNE ASSOCIATED PLANT COMMUNITIES OUTSIDE DESIGNATED DUNE FORMATIONS, MICHIGAN NATURAL FEATURES INVENTORY REFERENCE CODE INDICATED.

SOURCE

STATE OF MICHIGAN ACT 245 RECESSION RATE MAPS & ATLAS OF CRITICAL DUNE AREAS

INFORMATION

MICHIGAN DEPARTMENT OF NATURAL RESOURCES
LAND AND WATER MANAGEMENT DIVISION
P.O. BOX 30828
LANSING, MI 48909
(517) 373-1958

Gis

GREAT LAKES INFORMATION SYSTEM
MICHIGAN DEPARTMENT OF NATURAL RESOURCES
LAND AND WATER MANAGEMENT DIVISION

02-00-93
amended 12-06-93
amended 12-28-93

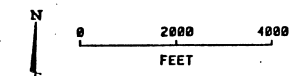

Parcels in High Risk Erosion Areas of Village of Elberta, Benzie County

HREAs identified North to South Date of Designation: December 20, 1993

HREA*	Sequence No.	Parcel Identification Number	Rate (feet/year)	30 yr PRD*	60 yr PRD*
A1	1	10-06-504-001-00 Sand Products Corp.	1.2	50	85

HREA* - Some parcels may be in multiple HREAs due to their large size.

30 yr PRD* is the Projected Recession Distance (feet) landward from the Erosion Hazard Line for readily moveable structures including those structures 3,500 square feet or less and built on a basement, crawlspace or pilings. Additional restrictions may apply per Administrative Rules 281.21-22.

60 yr PRD* is the Projected Recession Distance (feet) landward from the Erosion Hazard Line for non-readily moveable structures such as large structures and septic systems.

Designation runs with the land including subsequent splits. Absence of a property number does not guarantee the property is located outside of an HREA. Contact the Great Lakes Shorelands Unit, Water Resources Division, DEQ in Lansing or the local DEQ field office for assistance.