

Menominee County  
Ingallston Township  
T.34N R.26 and 25W

 WIDE SHADED BAND  
DEMARKS HIGH RISK  
EROSION AREA

 60-year projected recession distance  
 30-year projected recession distance

R.26W R.25W

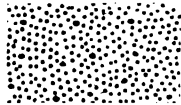
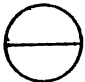
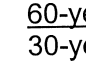
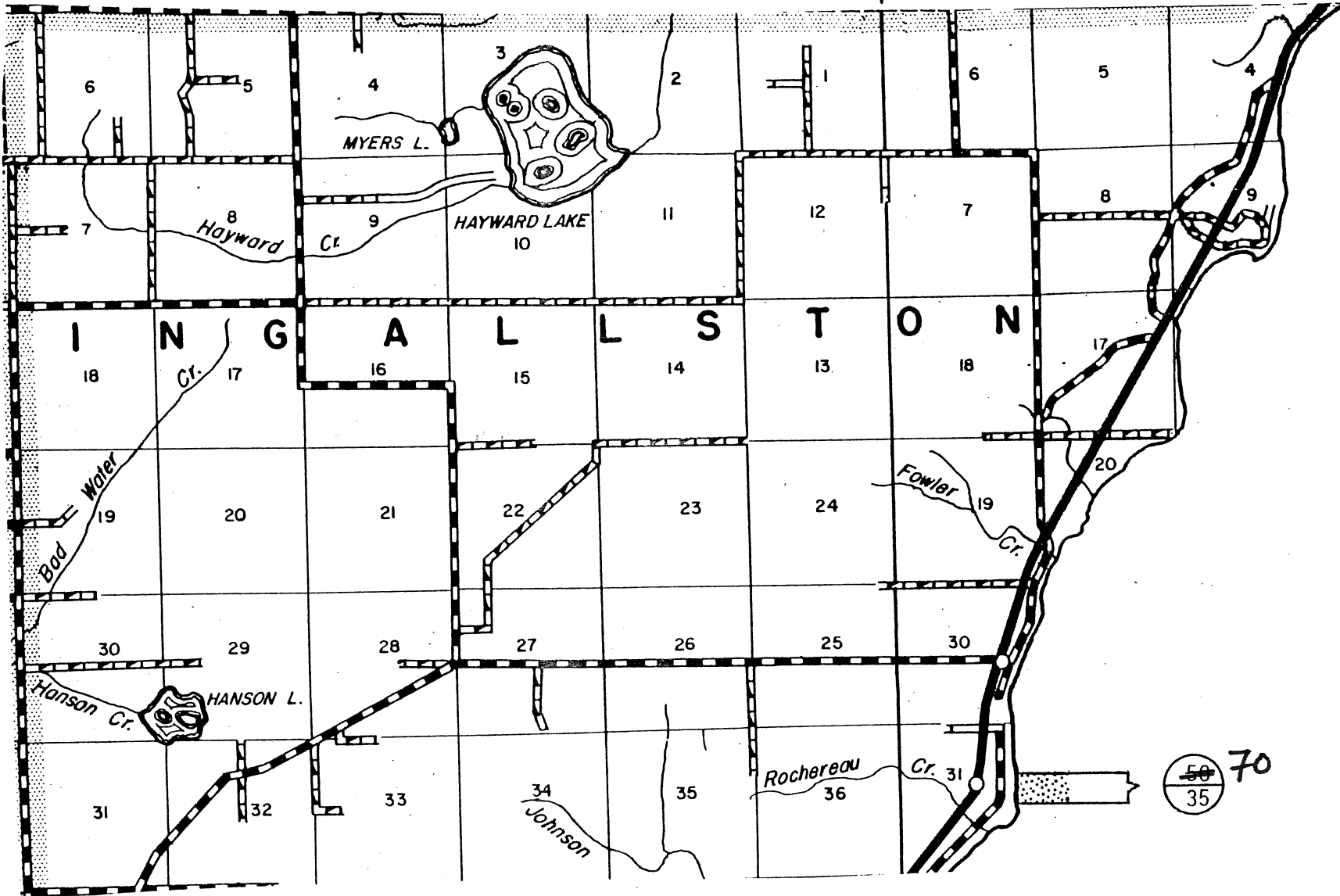

Menominee County  
Ingallston Township  
T.33 and 32N R.26W,R.25W

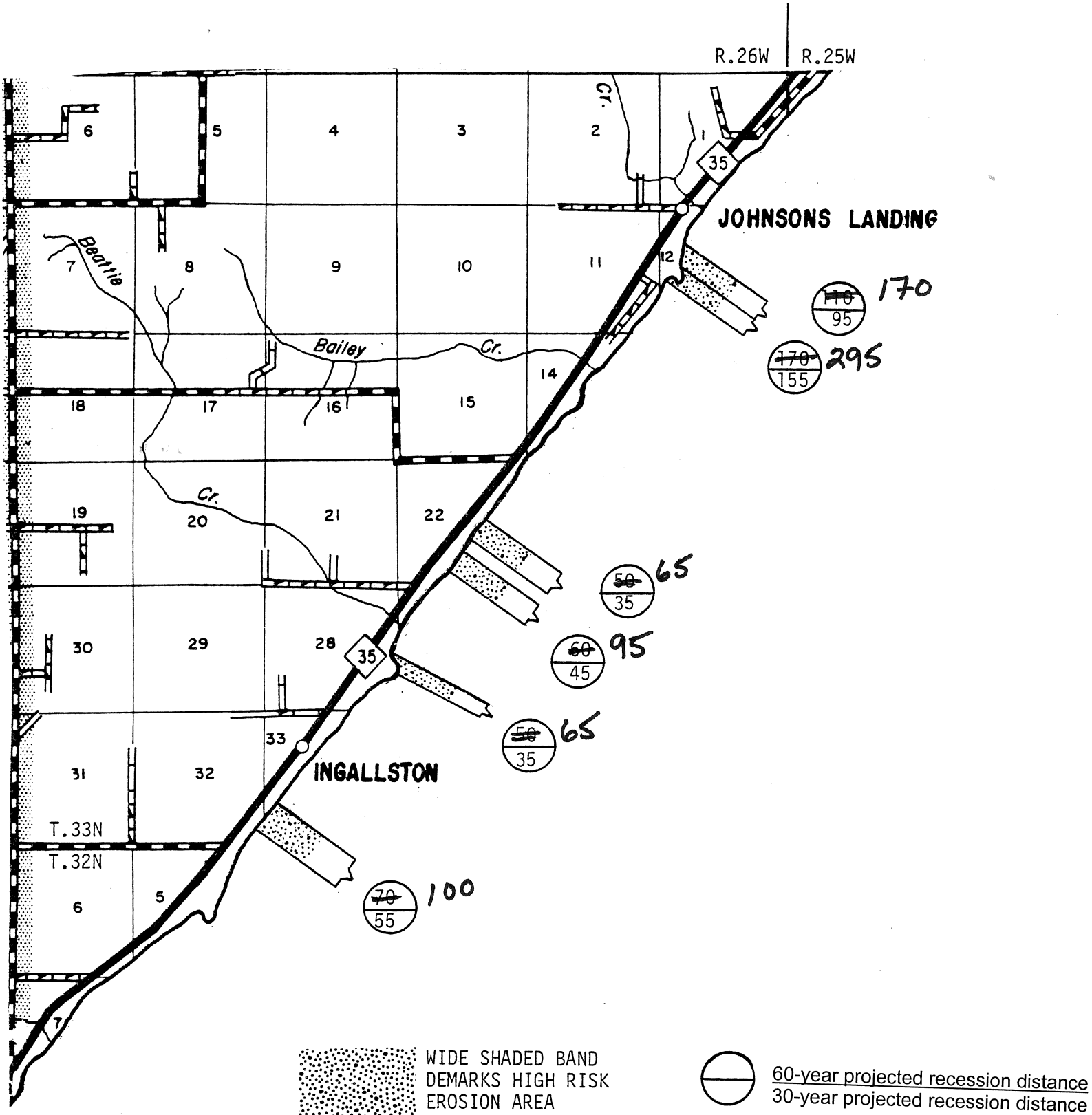

# Parcels in High Risk Erosion Areas of Ingallston Township, Menominee County

HREAs identified North to South      Date of Designation: October 23, 1985

HREA*	Sequence No.	Parcel Identification Number	Rate (feet/year)	30 yr PRD*	60 yr PRD*
A1	1	55-007-031-013-00	1.2	35	70
B1	2	55-007-312-017-00	2.6	95	170
B1	3	55-007-312-018-00	2.6	95	170
B1	3.1	55-007-312-019-00	2.6	95	170
B1	4	55-007-312-020-00	2.6	95	170
B1	4.1	55-007-312-021-00	2.6	95	170
B1	5	55-007-312-022-00	2.6	95	170
B2	5	55-007-312-022-00	4.7	155	295
B2	6	55-007-312-023-00	4.7	155	295
B2	7	55-007-312-024-00	4.7	155	295
B2	8	55-007-312-025-00	4.7	155	295
B2	9	55-007-312-026-00	4.7	155	295
B2	9.1	55-007-312-028-00	4.7	155	295
B2	9.11	55-007-312-029-00	4.7	155	295
C1	12	55-007-322-012-00	1.1	35	65
C1	11	55-007-322-013-00	1.1	35	65
C1	10	55-007-322-014-00	1.1	35	65
C1	13	55-007-322-017-00	1.1	35	65
C1	14	55-007-322-018-00	1.1	35	65

HREA\* - Some parcels may be in multiple HREAs due to their large size.

30 yr PRD\* is the Projected Recession Distance (feet) landward from the Erosion Hazard Line for readily moveable structures including those structures 3,500 square feet or less and built on a basement, crawlspace or pilings. Additional restrictions may apply per Administrative Rules 281.21-22.

60 yr PRD\* is the Projected Recession Distance (feet) landward from the Erosion Hazard Line for non-readily moveable structures such as large structures and septic systems.

**Designation runs with the land including subsequent splits. Absence of a property number does not guarantee the property is located outside of an HREA. Contact the Great Lakes Shorelands Unit, Water Resources Division, DEQ in Lansing or the local DEQ field office for assistance.**

# Parcels in High Risk Erosion Areas of Ingallston Township, Menominee County

HREAs identified North to South      Date of Designation: October 23, 1985

HREA*	Sequence No.	Parcel Identification Number	Rate (feet/year)	30 yr PRD*	60 yr PRD*
C1	16	55-007-322-019-00	1.1	35	65
C1	15	55-007-322-024-00	1.1	35	65
C1	17	55-007-797-001-00	1.1	35	65
D1	19	55-007-322-021-00	1.6	45	95
D1	18	55-007-322-025-00	1.6	45	95
D1	19	55-007-322-026-00	1.6	45	95
D1	20	55-007-322-032-00	1.6	45	95
E1	21	55-007-328-004-00	1.1	35	65
E1	22	55-007-328-006-00	1.1	35	65
E1	22.1	55-007-540-001-00	1.1	35	65
E1	23	55-007-540-002-00	1.1	35	65
E1	24	55-007-540-003-00	1.1	35	65
F1	25	55-007-333-020-00	1.4	55	100

HREA\* - Some parcels may be in multiple HREAs due to their large size.

30 yr PRD\* is the Projected Recession Distance (feet) landward from the Erosion Hazard Line for readily moveable structures including those structures 3,500 square feet or less and built on a basement, crawlspace or pilings. Additional restrictions may apply per Administrative Rules 281.21-22.

60 yr PRD\* is the Projected Recession Distance (feet) landward from the Erosion Hazard Line for non-readily moveable structures such as large structures and septic systems.

**Designation runs with the land including subsequent splits. Absence of a property number does not guarantee the property is located outside of an HREA. Contact the Great Lakes Shorelands Unit, Water Resources Division, DEQ in Lansing or the local DEQ field office for assistance.**